

REVISIONS	BY
NEW ELECTRIC SERVICE	WA

PROJECT DESCRIPTION:
Renovate the existing, former maintenance garage into a project shop for the school to teach hands on skills in bicycle repair and similar work. The facility will be used intermittently. (to be used less than 20 hours per week and be vacant the rest of the week.)

No new space is included in this project. It is merely to make the space more useable.

EXISTING STRUCTURE:
The existing building is a steel framed structure with a flat, built-up roof and block and brick sidewalls.

SITWORK: Remove remnants of the existing paving and install a 6" concrete slab with 6x6 10/10 w.w. mesh over a 6" STONE BASE.

Dimensions: 21'x100'

EXISTING BUILDING AREA: 3061 SF

CONSTRUCTION TYPE: 2B

CLASSIFICATION: EDUCATION/SHOP

MAXIMUM OCCUPANCY: 61 PEOPLE.

OCCUPANCY SCHEDULE: INTERMITTENT

(less than 20 hours per week used as a shop and vacant the rest of the time)

LIGHTING AREA DENSITY: 1.02 W/SF
LIGHTING DENSITY ALLOWED: 1.4 W/SF

HVAC SYSTEM: Due to the intermittent use of the building and the often opening of the overhead doors, the proposed heating is to be supplied by (4) 50,000 btuh radiant tube heaters with sealed combustion, outdoor combustion air intake and exhaust. Outdoor air/ventilation is to be provided during occupied periods with a 1500 CFM make-up air unit with a motorized exhaust relief damper. The two restrooms will be heated each with a resistance electric baseboard heater and air will be exhausted with an exhaust fan interlocked with the occupancy sensor/light switch.

BUILDING SKIN ALTERATION:
No changes removal of one overhead door and minor repair.

Sunstructures Architects
5750 Prospect Hill, Grass Lake, MI 49240 (734)894-5650

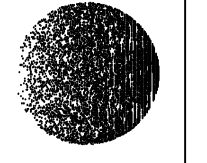

SITE PLAN

DETROIT COMMUNITY SCHOOL

Bagley Quad Shop Renovation
12675 BURT ROAD, DETROIT, MI

DRAWN BY: WA/WA CHECKED BY: WA

DATE: 1/10/2016

SCALE: 1"=40.00'

JOB NO.: 1601

SHEET

1

STATE PROJECT NO: 111008-WAYNE

TABLE OF CONTENTS

- 1 SITE PLAN
- 2 PLANS, ELEVATIONS & ROOF PLANS
- 3 MECHANICAL & PLUMBING
- 4 ELECTRICAL

Bagley Quad shop site plan March 2016
5/26/2016

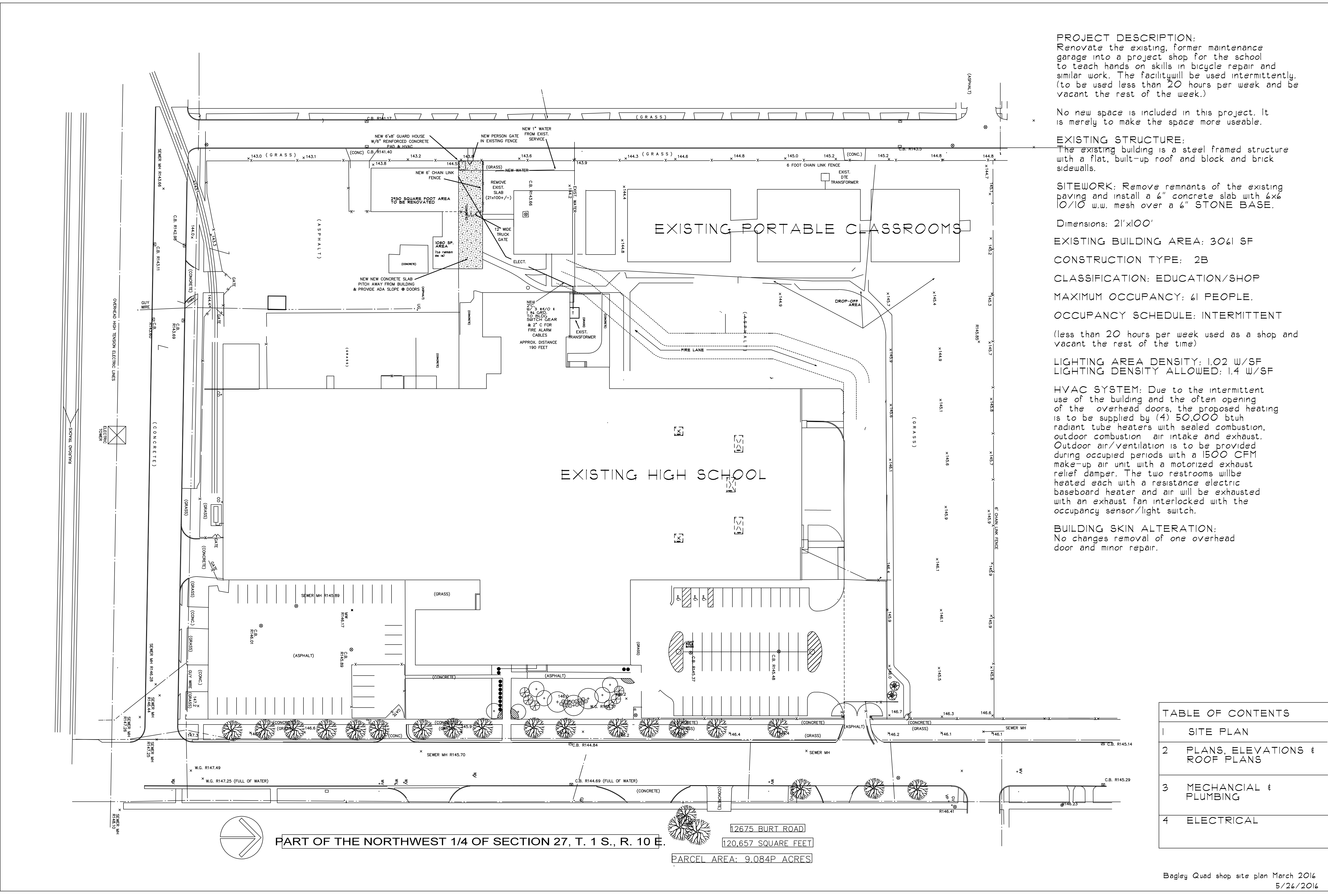

PART OF THE NORTHWEST 1/4 OF SECTION 27, T. 1 S., R. 10 E.

12675 BURT ROAD

120,657 SQUARE FEET

PARCEL AREA: 9.084P ACRES